

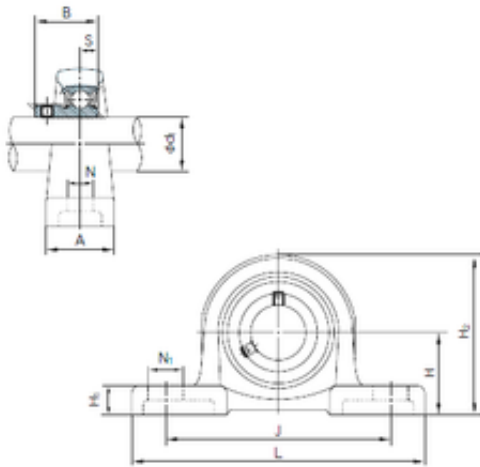

**NACHI BLLP5J bearing units**

Bearing No. BLLP5J



BLLP5J Bearing 2D drawings and 3D CAD models

Bore Diameter	25 mm
Width	27 mm
d	25 mm
A	29 mm
B	27 mm
H	36.5 mm
H1	13 mm
H2	70 mm
J	100 mm
L	130 mm
N	12 mm
N1	16 mm
S	7.5 mm
Bolt (G)	M10